

FICO DIAPHRAGM SEAL

TYPE: CT136 - GENERAL PURPOSE CLAMPED SEAL

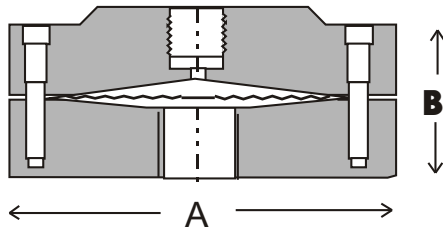

The model CT136 Diaphragm pressure seal with its 73mm diameter diaphragm is designed for general purpose use with instruments requiring higher displacement, and with lower measuring ranges, such as differential pressure transmitters. Its clamped construction allows flexibility in selection of top, bottom and diaphragm materials while retaining cost effectiveness. An optional 1/8" or 1/4" flushing connection can be provided in the lower housing.

Dimensions	mm
A	108.00
B	50.75

FICO Diaphragm pressure seals can be used in conjunction with pressure transmitters, gauges, switches and most other pressure instruments.

Pressure Range: -70 to 21,000kPa @ 25°C

* Drawing schematic only. Design subject to change without notice.

How To Order: CT136 KN KP C C S SL

Table A

Style - Clamped	Code
Old Part No.136A1	CT133
Old Part No.136A5	

Table B

Process Connection	Code
3/8" BSPF	KP
1/2" BSPF	KN*
1/2" NPTF	04
3/4" NPTF	08
3/4" BSPF	K2

Table C

Instrument Connection	Code
3/8" BSPP	KP*
1/2" BSPP	KN
1/2" NPT	04
1/4" BSPP	KJ
1/4" NPT	02
Option	XX

Table D

Top Housing	Code
316s/s	S
Carbon Steel	C*
Other	X

Table E

Bottom Housing	Code
316s/s	S
Carbon Steel	C*
Hast Alloy	H
Teflon	T
Rylon	R
Monel	M

* Denotes standard type.

Table F

Diaphragm	Code
316L	S*
Hast. C	H
Tantalum	T
Monel	M
Other	X

Table G

Fill Fluid	Code
Glycerine	CG
Silicon	SL*
High Temperature	HS
Silicone	
Food Grade	FG
Oxygen Service	OX

NOTE: 316 stainless steel armoured capillary available - specify length and instrument connection

CAUTION! Correct selection, fitting, filling, and testing of the combined Diaphragm Seal and pressure instrument is vital to achieve optimum performance. APS provide a complete filling, fitting and test service and can fit diaphragm seals to your instrument, free issued, or supply most pressure instruments required. Contact your closest APS branch for application assistance.

Manufactured by Austral-Powerflo Solutions Pty Ltd

NATIONAL HOTLINE 1300 658 701

SYDNEY • BRISBANE • MELBOURNE • PERTH



AUSTRAL - POWERFLO
SOLUTIONS