

# FICO DIAPHRAGM SEAL

## TYPE: PA THREADED PLUG SEAL

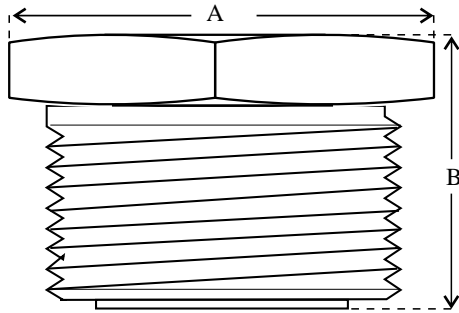

Dimensions (mm)	Size		
	25mm	40mm	50mm
A (across flats)	36	50	61
B	31	37	41

\* Drawing schematic only. Design subject to change without notice.

The PA Threaded plug diaphragm seal uses a welded diaphragm and 316 stainless steel plug and is specifically designed to be both economical and easily removed for cleaning. Applications include slurries, chemical industry, pulp and paper and waste treatment industry. The PA screws into a standard bsp taper socket and it's design minimises the possibility of buildup on the diaphragm. Ideally the PA is screwed into a standard bspt female threaded ball valve which serves to isolate the seal for easy installation and removal for cleaning. The PA seal includes a top fill port for ease of evacuation.

FICO Diaphragm pressure seals can be used in conjunction with pressure transmitters, gauges, switches and most other pressure instruments.

Pressure Range: -70 to 21000kPa @ 25°C

How To Order: PA40 04 S O S SL

Table A - Process Connection

Style - Threaded Plug	Code
	PA25
	PA40
	PA50
Option - Specify Size	PAXX

Table B

Instrument Connection	Code
3/8"BSPF	KP
	04*
	O2
	KA
Option	XX

Table C

Top Housing	Code
316s/s	S*

Table D

Bottom Housing	Code
None	O*
Supply Isolating Ball Valve To Suit	V <sup>(1)</sup>

Table E

Diaphragm	Code
316L	S*
Hast. C	H

Table F

Fill Fluid	Code
Glycerine	FG
Silicone	SL*
High Temperature Silicone	HS
Food Grade	FG
Oxygen Service	OX

\* Denotes standard type. (1) Specify materials and pressure rating separately.

NOTE: 316 stainless steel armoured capillary available - specify length and instrument connection required for end fittings.

**CAUTION!** Correct selection, fitting, filling, and testing of the combined Diaphragm Seal and pressure instrument is vital to achieve optimum performance. APS provide a complete filling, fitting and test service and can fit diaphragm seals to your instrument, free issued, or supply most pressure instruments required. Contact your closest APS branch for application assistance.

Manufactured by Austral-Powerflo Solutions Pty Ltd

NATIONAL HOTLINE 1300 658 701

SYDNEY • BRISBANE • MELBOURNE • PERTH



AUSTRAL - POWERFLO SOLUTIONS