

# FICO DIAPHRAGM SEAL

**TYPE: TF - GLASS FILLED TEFLON BOTTOM HOUSING  
FLANGED 15MM 150LB ANSI DESIGN**

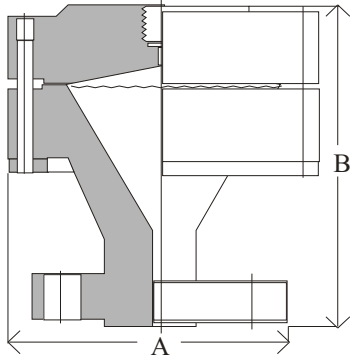

The model TF Diaphragm pressure seal is designed for service where corrosive, viscous or waxy process fluids mean a non-metallic glass filled teflon bottom housing is suitable. Standard is with ANSI 15mm 150lb (1/2") flange connection.

FICO Diaphragm pressure seals can be used in conjunction with pressure transmitters, gauges, switches and most other pressure instruments.

Pressure Range: -70kPa to maximum 800kPa (Higher ranges on application).

Dimension (mm)	15mm (to 150lb ANSI)
A	108
B	105

\* Drawing schematic only. Drawing subject to change without notice.

How To Order: TF150 015 KP C T S SL

Table A

Style - T eflon Flanged	Code
Old Part No.136A4	TF150

Table B

Flange Size	Code
15mm (1/2")	015

Table C

Instrument Connection	Code
3/8"BSPP	KP*
1/2"BSPP	KN
1/2"NPT	04
1/4"BSPP	KJ
1/4"NPT	02
Option	XX

Table D

Top Housing	Code
316ss	S
Carbon Steel	C*
Other	X

Table E

Bottom Housing	Code
Teflon	T

Table F

Diaphragm	Code
316ss	S*
Hast. C	H
Tantulum	T
Monel	M
Other	X

Table G

Fill Fluid	Code
Glycerine	CG
Silicon	SL*
High T emperature	HS
Silicone	
Food Grade	FG
Oxygen Service	OX

\* Denotes standard type.

NOTE: 316 stainless steel armoured capillary available - specify length and instrument connection required for end fittings.

**CAUTION!** Correct selection, fitting, filling, and testing of the combined Diaphragm Seal and pressure instrument is vital to achieve optimum performance. APS provide a complete filling, fitting and test service and can fit diaphragm seals to your instrument, free issued, or supply most pressure instruments required. Contact your closest APS branch for application assistance.

**Manufactured by Austral-Powerflo Solutions Pty Ltd**

**NATIONAL HOTLINE 1300 658 701**

**SYDNEY • BRISBANE • MELBOURNE • PERTH**



**AUSTRAL - POWERFLO  
SOLUTIONS**