

# A9H

## HS stem

### instrument valve

#### specifications

Angle needle valve model A9H is specially designed for gas service and liquid applications, where complete isolation or throttling of the media is required. This valve is available with a standard stem type HS with a conical metal tito ensure perfect alignment for a bubble tight shut-off.

pressure in bar	400
max. temperature in °C	550
needle tip	stainless steel
material	stainless steel
angle	90 °
gland packing	PTFE
stem packing area	burnished mirror finish for smooth valve operation
safety	back seating for preventing stem blowout

#### optional

angle body	45 degrees
------------	------------



model FF

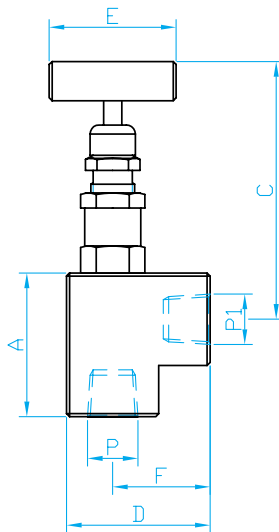

model MF

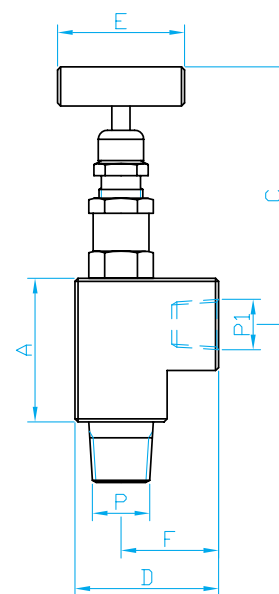

#### valve dimensions

model	port connections		dimensions in mm					
	inlet	outlet	A	C	D	E	E*	F
A9H	1/4" female	1/4" female	32	62	32	40	45	20
A9H	3/8" female	3/8" female	40	62	40	26	40	26
A9H	1/2" female	1/2" female	50	84	50	55	60	32
A9H	3/4" female	3/4" female	60	108	60	55	60	40
A9H	1" female	1" female	68	108	68	55	60	45
A9H	1/4" male	1/4" female	38	62	38	40	55	24
A9H	1/2" male	1/2" female	50	84	50	55	60	32

E = T-bar, E\* = circular